

Messuhren

S_Dial

ABHEBEVORRICHTUNGEN



Unterer Anlufthebel 905.4214



Oberer Anlufthebel 905.4215



Pneumatische Abhebevorrichtung 905.2218



Vakuum Abhebevorrichtung 905.2220



Abhebevorrichtung mit Fotokabel 905.2216



Anlufthebel 905.2214



Oberer Anlufthebel 905.2215

ZUBEHÖR

Messtastergewinde M2.5

S233
S234 (905.4321)
S234 (905.4322)
S_Dial WORK
12,5 - 25 mm
S_Dial WORK
50 - 150 mm
S_Dial ONE

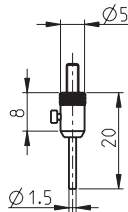
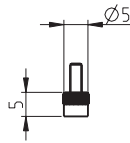
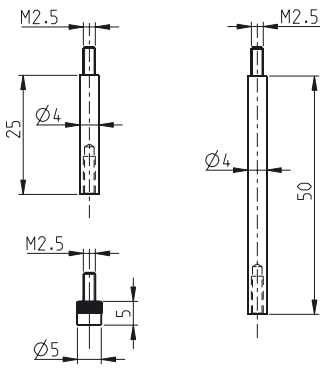

905.2201

905.2202

905.2203

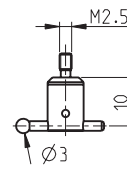
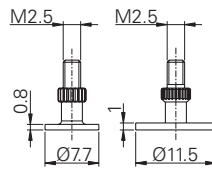
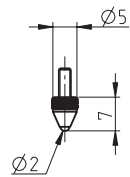

905.2206

905.2204

905.2205

905.2207

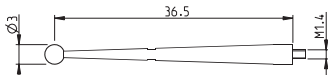
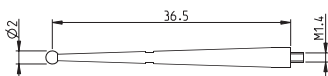
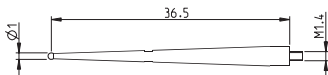
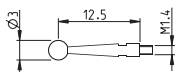
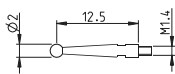
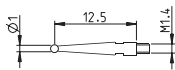

905.2240

Kurzer Taster, Hartmetallkugel

905.2241

Kurzer Standard Taster, Hartmetallkugel

905.2242

Kurzer Taster, Hartmetallkugel

905.2243

Langer Taster, Hartmetallkugel

905.2244

Langer Standard Taster, Hartmetallkugel

905.2245

Langer Taster, Hartmetallkugel

Messuhren

S_Dial

ZUBEHÖR

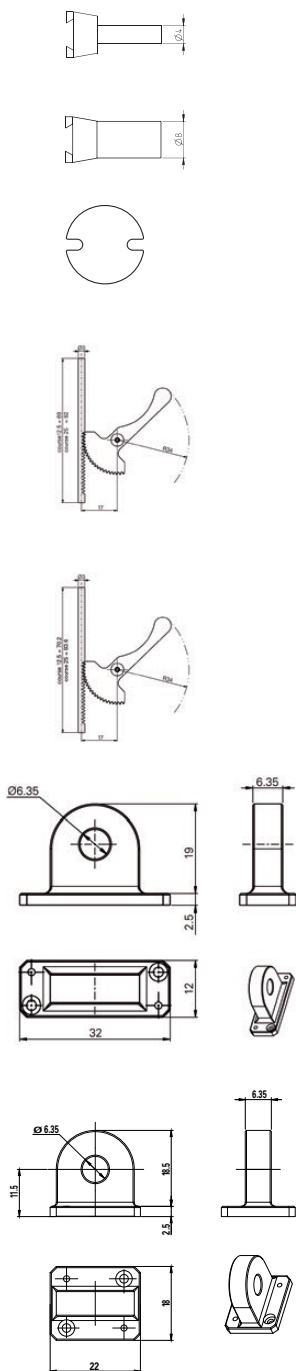

		S233	S234	S_Dial WORK 12,5 - 25 mm	S_Dial WORK 50 - 150 mm	S_Dial ONE
905.2246	Einspannschaft	•	•			
905.2247	Einspannschaft	•	•			
905.2248	Tasterschlüssel		•			
905.0214	Anlüfthebel für Messweg 12.5 mm					•
905.0215	Anlüfthebel für Messweg 25 mm					•
905.0216	Anlüfthebel für Messweg 50 mm					•
805.0214	Anlüfthebel für Messweg 12.5 mm			• ¹⁾		
805.0215	Anlüfthebel für Messweg 25 mm			• ¹⁾		
905.0211	Ösendeckel					•
805.0211	Ösendeckel			• ¹⁾	• ¹⁾	

¹⁾ S_Dial WORK Basic ausgenommen

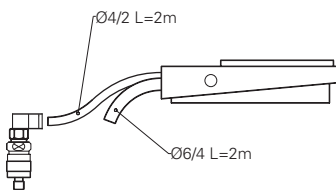
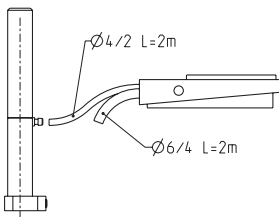
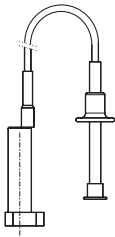
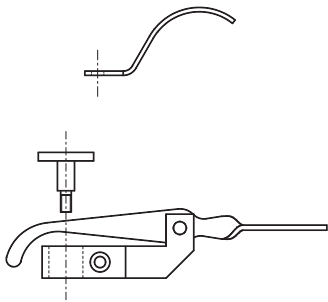

		S233	S234	S_Dial WORK 12,5 - 25 mm	S_Dial WORK 50 - 150 mm	S_Dial ONE
905.2214	Anlüfthebel	•		•	•	•
905.2215	Anlüfthebel oben			•		
905.2216	Abhebevorrichtung mit Fotokabel			•		
905.2218	Pneumatische Abhebevorrichtung mit Pedal			•		
905.2217	Zylinder für 905.2218			•		
905.2219	Pneumatisches Pedal für 905.2218	•		•		
905.2220	Vakuum Abhebevorrichtung mit Pedal				•	
905.2227	Druckregler für 905.2220				•	
905.2228	Vakuum Pedal für 905.2220				•	

Messuhren

S_Dial

ZUBEHÖR

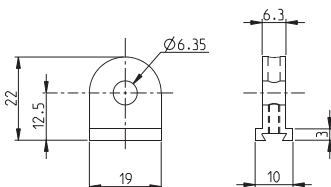
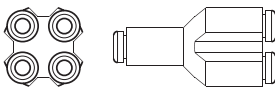
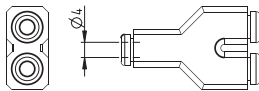
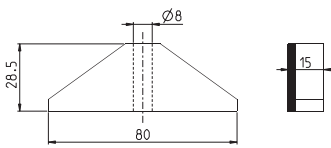
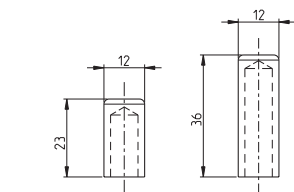

		S233	S234	S_Dial WORK 12,5 - 25 mm	S_Dial WORK 50 - 150 mm	S_Dial ONE
905.2221	Abdeckkappe für Messuhr 12.5 mm			•		
905.2222	Abdeckkappe für Messuhr 12.5 mm			•		
905.2223	Tiefenmessbrücke			•	•	•
905.2261	Schnellverbindung für pneumatische Abhebung x2	•		•	•	
905.2262	Schnellverbindung für pneumatische Abhebung x4	•		•	•	
905.4211	Rückwanddeckel mit Öse	•	•			

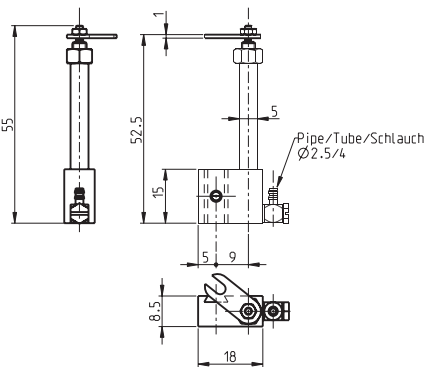
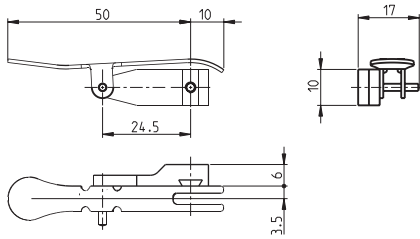
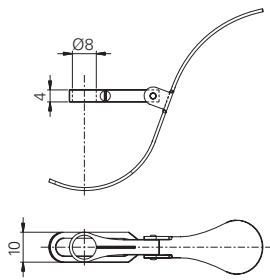

		S233	S234	S_Dial WORK 12,5 - 25 mm	S_Dial WORK 50 - 150 mm	S_Dial ONE
905.4214	Unterer Anlüfthebel für Messuhren 12.5 mm	●	1)	1)	1)	1)
905.4215	Oberer Anlüfthebel für Standardausführung S Ausgenommen Modell Vertikal	●				
905.4217	Pneumatische Abhebevorrichtung Für Standardausführung S	●				

¹⁾ Anlüftung max. 20 mm